

Cannabis Buffers of Towpath and Prallsville Mill

Borough of Stockton
Hunterdon County, NJ
December 2024

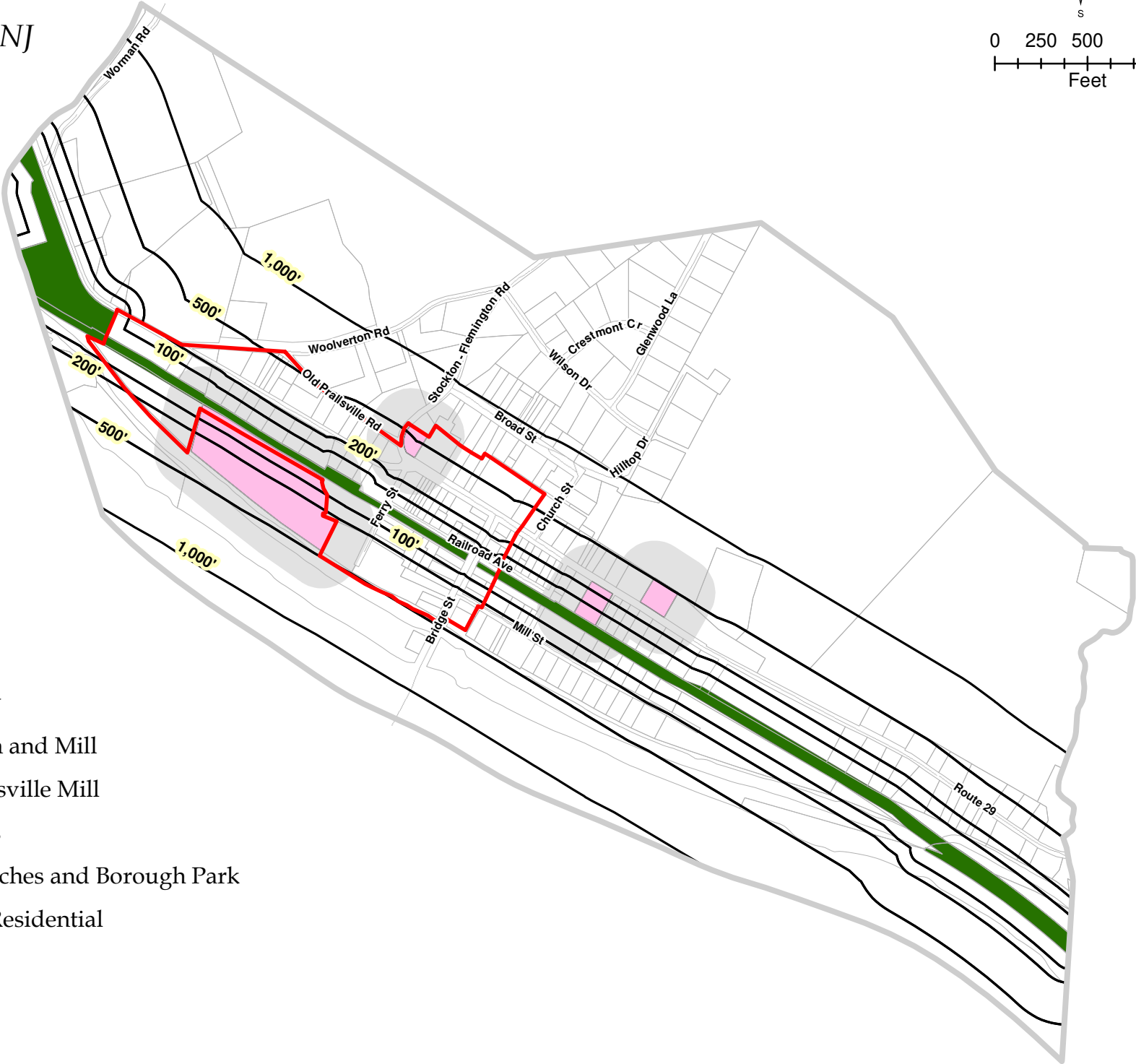
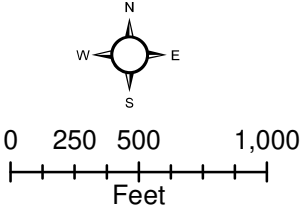

Legend

- Borough Boundary
- Buffers of Towpath and Mill
- Towpath and Prallsville Mill
- Park and Churches
- 200' Buffer of Churches and Borough Park
- CR - Commercial Residential

Data Sources:
Hunterdon County Parcels
NJDOT Roadway Network